



Weather Station

MeteoTrend Colour

Art. No. 7007310CM3000

EN Instruction Manual

Contents

1 Imprint	3
2 Features.....	3
3 About this Instruction Manual	3
4 General safety instructions	4
5 Parts overview and scope of delivery	6
6 Screen display	7
7 Before starting operation.....	8
8 Setting up power supply.....	8
9 Automatic time setting.....	8
10 Manual time setting	8
11 Alarm setting.....	9
12 Snooze function.....	9
13 Receiving measurements automatically	9
14 Manual measurement display	9
15 Weather trend display	9
16 Disposal.....	10
17 EC Declaration of Conformity	10
18 Warranty	10

1 Imprint

Bresser GmbH
Gutenbergstraße 2
46414 Rhede
Deutschland
<http://www.bresser.de>

For information regarding liability claims or service requests, please refer to chapters "Warranty" and "Service" in this documentation. We ask for your understanding, that any requests or submissions that have been addressed to the manufacturer's address can not be processed.

Errors reserved - technical specifications subject to change.

Copyright: 2016Bresser GmbH

All rights reserved.

It is not allowed to reproduce this documentation or parts of it in any kind (e.g. photocopying, printing, etc) without written a permission of the manufacturer. It is also prohibited to use or transmit this documentation with electronic systems (e.g. image file, website, etc).

The descriptions and brand names of the corresponding firms used in this documentation are generally protected under trademark, brand and/or patent law for Germany, for the European Union and/or other countries.

2 Features

- Graphical 12-hours weather trend display
- Radio-controlled clock with DCF signal reception and display
- Alarm with snooze function
- Outdoor temperature alarm (frost warning)
- Outdoor temperature (in °C or °F)
- Indoor temperature (in °C or °F)
- Highest and lowest value display
- Incl. Thermo sensor and power adapter
- Coloured display background
- Can be placed on a flat surface

3 About this Instruction Manual



NOTICE

These operating instructions are to be considered a component of the device.

Please read the safety instructions and the operating instructions carefully before use.

Keep these instructions for renewed use at a later date. When the device is sold or given to someone else, the instruction manual must be provided to the new owner/user of the product.

4 General safety instructions



⚠ DANGER

Danger of an electric shock!

This device contains electronic components that operate via a power source (power supply and/or batteries). In case of any improper use of this device, there is a risk of an electric shock. An electric shock can cause severe injury or even death. Therefore please read the safety instructions below to avoid an explosion.

- Children must only use the device under adult supervision! Only use the device as described in the manual; otherwise, you run the risk of an electric shock.
- Disconnect the device from the power supply by pulling the power plug when it is not used or in case of longer interruption of operation and before starting any work on maintenance and cleaning.
- Position your device so that it can be disconnected from the power supply at any time. The wall socket you use should be located near the device and easily accessible, since the plug on the power cable serves as a disconnecting device for the power supply.
- Always pull on the plug to separate the device from the power supply. Never pull on the cable.
- Before operating, check the device, cables and connections for damage.
- Never use a damaged unit or a unit with damaged power cables. Damaged parts must be exchanged immediately by an authorised service centre.
- Only use the device in complete dry environment and do not touch it with wet or moist parts of your body.



⚠ DANGER

Danger of choking!

In case of any improper use of this device, there is a risk of choking, especially for children. Therefore please read the safety instructions below.

- Keep packaging material, like plastic bags and rubber bands, out of the reach of children, as these materials pose a choking hazard!
- This product contains small parts that could be swallowed by children. There is a risk of choking!



⚠ DANGER

Danger of explosion!

In case of any improper use of this device, there is a risk of an explosion. Therefore please read the safety instructions below to avoid an explosion.

- Do not expose the device to high temperatures. Use only the supplied power supply or the recommended batteries. Do not short-circuit the device or batteries or throw them into a fire! Excessive heat or improper handling could trigger a short circuit, a fire, or an explosion.



NOTICE

Risk of property damage!

In case of any improper use of this device and/or its accessories, there is a risk of property damage. Therefore only use the device according to the safety instructions below.

- Do not disassemble the device. In the event of a defect, please contact your dealer. The dealer will contact the Service Centre and can send the device in to be repaired, if necessary.
- Do not expose this device to higher temperatures and protect it from water and high humidity.

- Do not immerse the unit in water!
- Protect the device from severe shocks!
- For this device only use accessories and spare parts that comply with the technical information.
- Use only the recommended batteries. Always replace weak or empty batteries with a new, complete set of batteries at full capacity. Do not use batteries from different brands or with different capacities. Remove the batteries from the unit if it has not been used for a long time.



NOTICE

Risk of voltage damage!

The manufacturer is not liable for voltage damage due to improperly inserted batteries or through the use of an improper power adapter!

5 Parts overview and scope of delivery

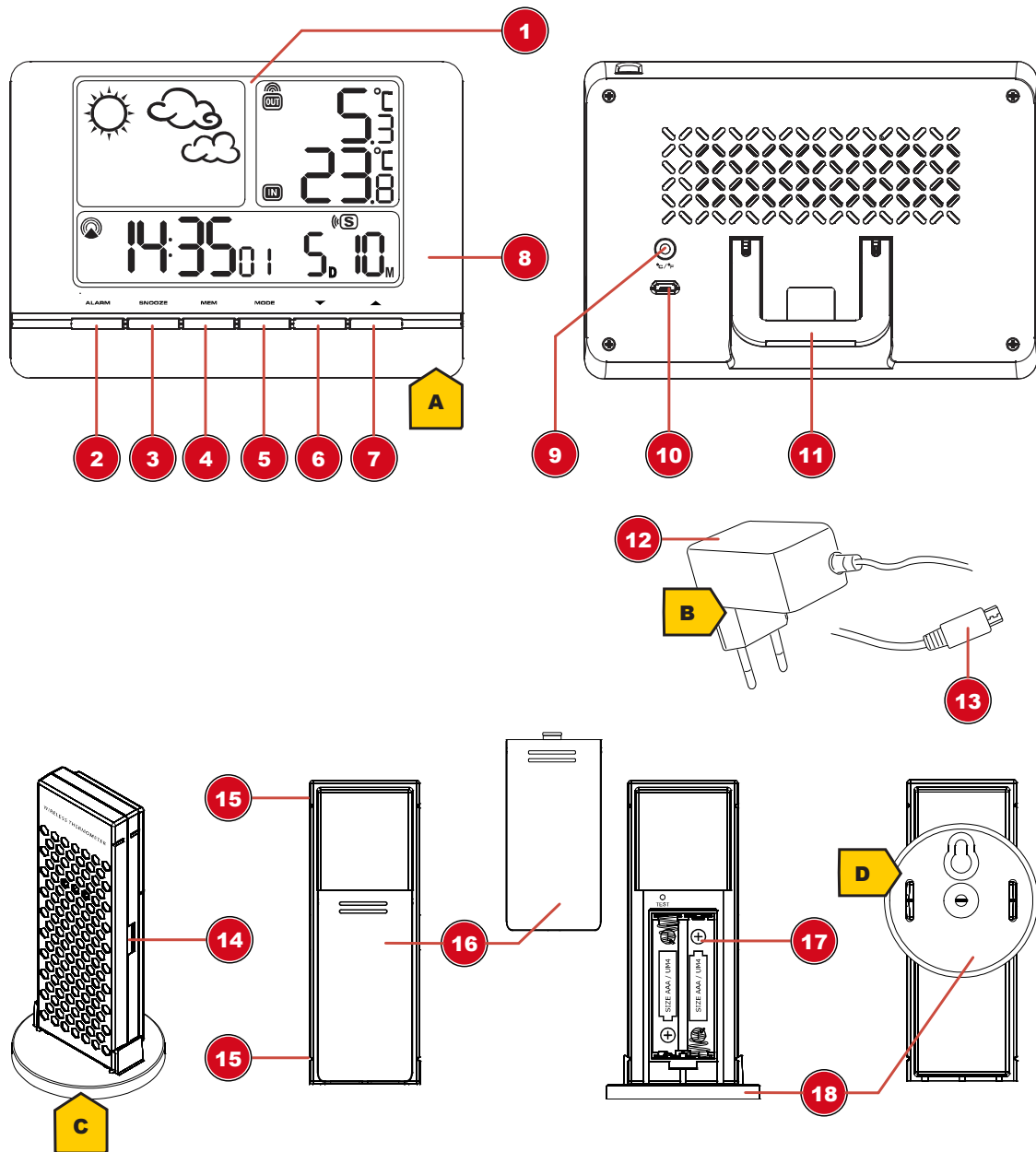

Illustration 1: Parts overview for base station (top) and remote sensor (bottom)

1 Display	2 ALARM button (Alarm setting)
3 SNOOZE button (snooze function)	4 MEM button (show recorded data)
5 MODE button (time mode selection)	6 DOWN button (Value setting downwards)
7 UP button (Value setting upwards)	8 Photo-optical sensor
9 °C/°F button	10 Micro-USB connection (Power supply)
11 Stand, fold-out	12 DC power adapter with EU mains plug.
13 Power cable with DC plug (Micro-USB)	14 Groove for mounting clip/stand
15 Groove for mounting clip/stand	16 Battery compartment cover
17 Battery compartment	18 Mounting clip/stand

Scope of delivery

Base station (A), power adapter (B), remote Sensor (C), mounting clip/stand (D)
 Recommended batteries (not included)
 2 pcs. Micro batteries (1.5V, AAA type)

6 Screen display

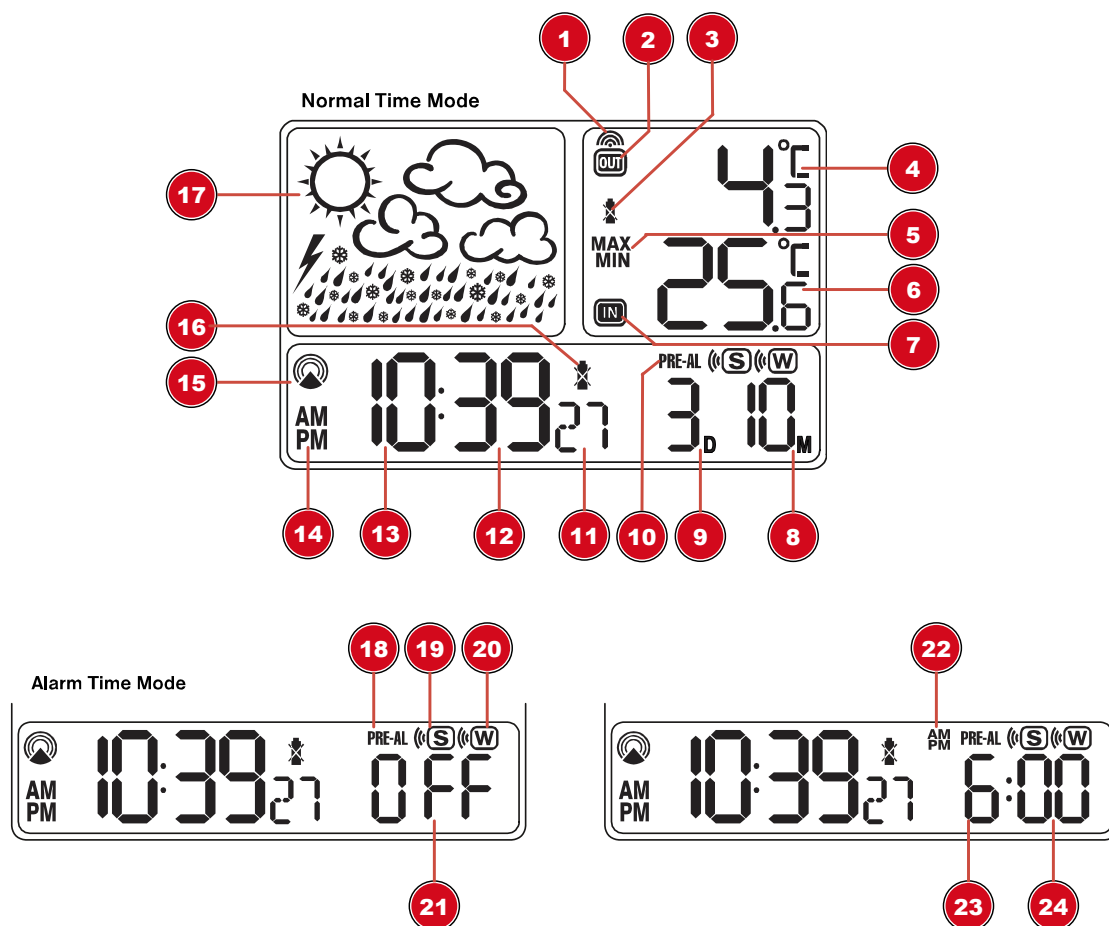

Illustration 2: Screen display for the base station

1 Signal reception symbol (remote sensor)	2 Temperature range symbol (remote sensor)
3 Battery level (remote sensor)	4 Outdoor temperature value (remote sensor)
5 Symbol for highest (MAX) or lowest (MIN) temperature	6 Indoor temperature value (base station)
7 Temperature range symbol (base station)	8 Date display (month)
9 Date display (day)	10 Alarm symbols (PRE-AL, S or W)
11 Current time (seconds)	12 Current time (minutes)
13 Current time (hours)	14 AM/PM information in 12-hour time mode
15 Time signal transmission symbol	16 Battery level (base station)
17 Graphical weather trend display	18 Alarm symbol PRE-AL (Frost warning)
19 Alarm symbol S (one-time)	20 Alarm symbol W (weekdays)
21 Alarm off	22 AM/PM information in 12-hour time mode
23 Alarm time (hours)	24 Alarm time (minutes)

7 Before starting operation



NOTICE

Avoid connectivity disruptions!

To avoid connectivity disruptions between the devices, consider the following points before starting operation.

1. Place base station (receiver) and remote sensor (sender) together as close as possible.
2. Set up power supply for the base station and wait approx. 5 seconds.
3. Set up power supply for the remote sensor.
4. Position the base station and the remote sensor within the effective transmission range.

When changing batteries always change batteries in the main unit as well as all remote units and replace them in the correct order, so the remote connection can be re-established. If either of the devices is mains-powered, the power supply must be disconnected for a short moment also for this device when exchanging the batteries. If batteries are exchanged in only one of the devices (i.e. the remote sensor) the signal can't be received or can't be received correctly.

Note, that the effective range is vastly affected by building materials and position of the main and remote units. Due to external influences (various RC devices and other sources of interference), the maximum distance can be greatly reduced. In such cases we suggest to position the main unit and the remote sensor at other places. Sometimes all it takes is a relocation of one of these components of a few inches! Though the remote unit is weather proof, it should be placed away from direct sunlight, rain or snow.

8 Setting up power supply

Base station

1. Put the DC connector into the connection socket of the base station.
2. Put the mains plug into the power outlet.
3. The device is energized directly.

Remote sensor

1. Remove the battery compartment cover.
2. Insert the batteries into the battery compartment. Ensure that the battery polarity (+/-) is correct.
3. Replace the battery compartment cover.

9 Automatic time setting

After the power supply was established, the clock will automatically search for the radio signal. This will take approximately 3 to 8 minutes to finish this process.

If the radio signal is received correctly, the date and time will be set automatically and the radio control signal icon turns on.

If the clock fails to receive the time signal, go ahead with the following steps:

1. Press and hold the UP button for 2 seconds to re-initialize RC signal receiving.
2. Is the device still not receiving the signal, the time must be set manually.

Read the detailed manual for more information about manual time and alarm time settings (see download information on page 2).

10 Manual time setting

1. Press and hold MODE button for approx. 3 seconds to change to time setting mode.

2. Digits to be set are flashing.
3. Press UP or DOWN button to change the value.
4. Press MODE button to confirm and continue to the next setting.
5. Settings order: Year > Month > Day > Change day and month > 12/24-hours mode > Hours > Minutes > Language > °C/°F
6. Finally press the MODE button to save the settings and exit the setting mode.

11 Alarm setting

1. Press ALARM button several times to select the desired alarm function: daily alarm (W) or single alarm (S).
2. Press UP button when an alarm function has been selected to activate the alarm. The display switches to the preset alarm time.
3. Press and hold ALARM button for approx. 3 seconds to enter the alarm time setting mode.
4. The value to be set flashes.
5. Press UP or DOWN button to change the value.
6. Press ALARM button to confirm and continue to the next setting.
7. Settings order: Hours > Minutes
8. Finally press the ALARM button to save the settings and exit the setting mode.

NOTICE! The pre-alarm (PRE-AL) can be activated only in combination with the daily (W) or single alarm (S). Once the pre-alarm is activated, an alarm will sound at a preset time (15, 30, 45, 60 or 90 minutes) before the actual alarm time and when the outdoor temperature is below 3 °C.

12 Snooze function

1. When the alarm sounds, press SNOOZE button to activate the snooze function. The alarm will sound again in 4 minutes.
2. Press AARM button when the alarm sounds to interrupt the alarm until the alarm time will be reached again.
3. The alarm will be turned off automatically if no button is pressed within 2 minutes.

13 Receiving measurements automatically

Once batteries are installed, the base station will display the indoor temperature readings. Readings from the remote sensor will be displayed within 3 minutes after powering it on.

Read the detailed manual for more information about readings (see download information on page 2).

14 Manual measurement display

1. Press MEM button several times to display the saved values one after another.
2. Display order: Current values > MIN (lowest values) > MAX (highest values)
3. Press MEM button for approx. 3 seconds during highest or lowest value display to irrevocable delete all saved values.

Saved highest and lowest values will be deleted automatically every day on 0:00!

15 Weather trend display

The weather station will calculate a weather trend for the next 12 hours on basis of the measured values.

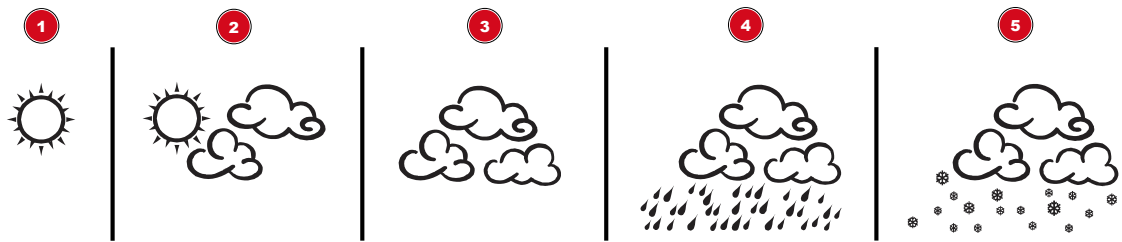

Illustration 3: Weather trend indicators

1 Sunny	2 Partly cloudy
3 Cloudy	4 Rain
5 Snow	

16 Disposal



Dispose of the packaging materials properly, according to their type, such as paper or cardboard. Contact your local waste-disposal service or environmental authority for information on the proper disposal.

Do not dispose of electronic devices in the household garbage!

As per Directive 2002/96/EC of the European Parliament on waste electrical and electronic equipment and its adaptation into German law, used electronic devices must be collected separately and recycled in an environmentally friendly manner.

In accordance with the regulations concerning batteries and rechargeable batteries, disposing of them in the normal household waste is explicitly forbidden. Please make sure to dispose of your used batteries as required by law — at a local collection point or in the retail market. Disposal in domestic waste violates the Battery Directive.

Batteries that contain toxins are marked with a sign and a chemical symbol. "Cd" = cadmium, "Hg" = mercury, "Pb" = lead.

17 EC Declaration of Conformity



Bresser GmbH has issued a "Declaration of Conformity" in accordance with applicable guidelines and corresponding standards.

18 Warranty

The regular guarantee period is 2 years and begins on the day of purchase. To benefit from an extended voluntary guarantee period as stated on the gift box, registration on our website is required.

You can consult the full guarantee terms as well as information on extending the guarantee period and details of our services at www.bresser.de/warranty_terms.

Service

DE AT CH BE

Bei Fragen zum Produkt und eventuellen Reklamationen nehmen Sie bitte zunächst mit dem Service-Center Kontakt auf, vorzugsweise per E-Mail.

E-Mail: service@bresser.de
Telefon*: +49 28 72 80 74 210

BRESSER GmbH
Kundenservice
Gutenbergstr. 2
46414 Rhede
Deutschland

*Lokale Rufnummer in Deutschland (Die Höhe der Gebühren je Telefonat ist abhängig vom Tarif Ihres Telefonanbieters); Anrufe aus dem Ausland sind mit höheren Kosten verbunden.

GB IE

Please contact the service centre first for any questions regarding the product or claims, preferably by e-mail.

e-mail: service@bresseruk.com
Telephone*: +44 1342 837 098

BRESSER UK Ltd
Unit 1 starborough Farm,
Starborough Road, Nr Marsh Green,
Edenbridge, Kent TN8 5RB
Great Britain

*Number charged at local rates in the UK (the amount you will be charged per phone call will depend on the tariff of your phone provider); calls from abroad will involve higher costs.

FR BE

Si vous avez des questions concernant ce produit ou en cas de réclamations, veuillez prendre contact avec notre centre de services (de préférence via e-mail).

e-mail: sav@bresser.fr
Téléphone*: 00 800 6343 7000

BRESSER France SARL
Pôle d'Activités de Nicopolis
260, rue des Romarins
83170 Brignoles
France

*Prix d'un appel local depuis la France ou Belgique

NL BE

Als u met betrekking tot het product vragen of eventuele klachten heeft kunt u contact opnemen met het service centrum (bij voorkeur per e-mail).

e-mail: info@folux.nl
Teléfono*: +31 528 23 24 76

Folux B.V.
Smirnoffstraat 8
7903 AX Hoogeveen
Nederlands

*Het telefoonnummer wordt in het Nederland tegen lokaal tarief in rekening gebracht. Het bedrag dat u per gesprek in rekening gebracht zal worden, is afhankelijk van het tarief van uw telefoon provider; gesprekken vanuit het buitenland zullen hogere kosten met zich meebrengen.

ES IT PT

Si desea formular alguna pregunta sobre el producto o alguna eventual reclamación, le rogamos que se ponga en contacto con el centro de servicio técnico (de preferencia por e-mail).

e-mail: servicio.iberia@bresser-iberia.es
Teléfono*: +34 91 67972 69

BRESSER Iberia SLU
c/Valdemorillo,1 Nave B
P.I. Ventorro del cano
28925 Alcorcón Madrid
España

*Número local de España (el importe de cada llamada telefónica dependen de las tarifas de los distribuidores); Las llamadas des del extranjero están ligadas a costes suplementarios.