



**EN** Operating instructions

# **ACTION CAMERA**

**PRO // ULTRA HD 4K WIFI**

**DE** Besuchen Sie unsere Website über den folgenden QR Code oder Weblink um weitere Informationen zu diesem Produkt oder die verfügbaren Übersetzungen dieser Anleitung zu finden.

**EN** Visit our website via the following QR Code or web link to find further information on this product or the available translations of these instructions.

**FR** Si vous souhaitez obtenir plus d'informations concernant ce produit ou rechercher ce mode d'emploi en d'autres langues, rendez-vous sur notre site Internet en utilisant le code QR ou le lien correspondant.

**NL** Bezoek onze internetpagina via de volgende QR-code of weblink, voor meer informatie over dit product of de beschikbare vertalingen van deze gebruiksaanwijzing.

**IT** Desidera ricevere informazioni esaustive su questo prodotto in una lingua specifica? Venga a visitare il nostro sito Web al seguente link (codice QR Code) per conoscere le versioni disponibili.

**ES** Visite nuestra página de Internet utilizando el siguiente código QR o el enlace web, para buscar más información sobre este producto o versiones disponibles del presente manual de instrucciones en diferentes idiomas.

**PT** Aceda à nossa página na Internet através do seguinte código QR ou hiperligação, para procurar outras informações sobre este produto ou os idiomas disponíveis deste manual de instruções.

**DK** Ønsker du en udførlig vejledning til dette produkt på et bestemt sprog? Så besøg vores website ved hjælp af følgende link (QR-kode) for tilgængelige versioner.

**PL** Odwiedź naszą stronę internetową, korzystając z kodu QR lub za pośrednictwem linka sieciowego, aby poszukać więcej informacji na temat tego produktu lub dostępnych wersji językowych niniejszej instrukcji obsługi.

**RU** Посетите нашу страницу в сети Интернет, используя QR-код или Web-ссылку, для получения дополнительной информации по данному устройству или для поиска доступных языковых версий данного руководства по эксплуатации.

**TR** Bu ürünle ilgili daha fazla bilgi ile bu klavuzun geçerli çevirileri için aşağıdaki Barkod Kodundan ya da web bağlantısından internet sitemizi ziyaret edin.



## FULL MANUAL & VIDEO DOWNLOAD:



[www.bresser.de/download/8785104](http://www.bresser.de/download/8785104)

## APP DOWNLOAD „OKCam“:



## SERVICE AND WARRANTY:



[www.bresser.de/warranty\\_terms](http://www.bresser.de/warranty_terms)

## About this Instruction Manual



Please read the safety instructions and the operating instructions carefully before use. Keep these instructions for renewed use at a later date. When the device is sold or given to someone else, the instruction manual must be provided to the new owner/user of the product.

## Intended Use

This product is intended only for private use. It was developed as an electronic medium for the use of multimedia services.



## General Warnings

- **Risk of choking** — Keep packaging material, like plastic bags and rubber bands, out of the reach of children, as these materials pose a choking hazard. This product contains small parts that could be swallowed by children.
- Leaking battery acid can lead to chemical burns. Avoid contact of battery acid with skin, eyes and mucous membranes. In the event of contact, rinse the affected region immediately with a plenty of water and seek medical attention.
- **Risk of electric shock** — Never bend, pinch or pull the power and connecting cables, extensions and adapters. Protect the cables from sharp edges and heat. Before operating, check the device, cables and connections for damage. Never use a damaged unit or a unit with damaged power cables. Damaged parts must be exchanged immediately by an authorised service centre.
- **Risk of property damage!** — Do not disassemble the device. In the event of a defect, please contact your dealer. The dealer will contact the Service Centre and can send the device in to be repaired, if necessary.
- Do not expose the device to high temperatures. Use only the supplied power adapter. Do not short-circuit the device or throw them into a fire. Excessive heat or improper handling could trigger a short-circuit, a fire or an explosion.

- Do not interrupt an on-going data connection to a computer before all data has been transferred. This could lead to data loss for which the manufacturer is not liable.

## Notes on cleaning

- Turn off the camera
- Clean the eyepieces and/or lenses only with a soft, lint-free cloth, (e.g. microfibre cloth). To avoid scratching the lenses, use only gentle pressure with the cleaning cloth.
- Only use a dry cloth to clean the exterior of the device. To avoid damaging the electronics, do not use any cleaning fluid.
- Clean the protective case after each use with clear, clean water and dry it thoroughly.

## EC Declaration of Conformity



Bresser GmbH has issued a Declaration of Conformity' in accordance with applicable guidelines and corresponding standards. This can be viewed any time upon request.

## Disposal



Dispose of the packaging materials properly, according to their type, such as paper or cardboard. Contact your local waste-disposal service or environmental authority for information on the proper disposal.



Do not dispose of electronic devices in the household garbage!  
As per the Directive 2002/96/EC of the European Parliament on waste electrical and electronic equipment and its adaptation into German law, used electronic devices must be collected separately and recycled in an environmentally friendly man-

ner. Empty, old batteries must be disposed of at battery collection points by the consumer. You can find out more information about the disposal of devices or batteries produced after 6 January 2006 from your local waste-disposal service or environmental authority.



The integrated battery must only be removed for disposal. Opening the device housing can damage the unit.

Drain the battery completely before disposal. Remove all the screws in the housing and open the device housing. Remove the connections to the battery and remove it. Cover the open contacts with tape and package the battery in such a way that it cannot shift in the packaging.

## Warranty & Service

The regular guarantee period is 2 years and begins on the day of purchase. To benefit from an extended voluntary guarantee period as stated on the gift box, registration on our website is required. You can consult the full guarantee terms as well as information on extending the guarantee period and details of our services at [www.bresser.de/warranty\\_terms](http://www.bresser.de/warranty_terms).

## Scope of delivery

EN

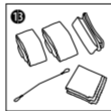
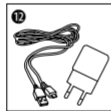
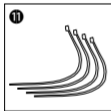
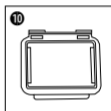
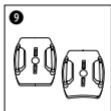
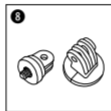
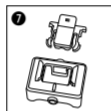
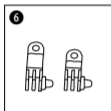
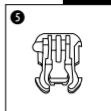
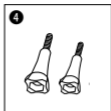
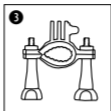
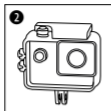
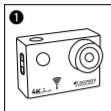

- 1 Camera
- 2 Waterproof case
- 3 Bicycle mount
- 4 Thumb knobs
- 5 Retaining clip for Base mount
- 6 Multifunction mounts
- 7 Camera housing and belt clip
- 8 1/4" Tripod adapter (male/female)
- 9 Base for flat and curved surface
- 10 Case door
- 11 Cable ties
- 12 USB cable and AC adapter
- 13 Straps, Wire rope and cleaning cloth

## First Steps

How to open and close the waterproof case:

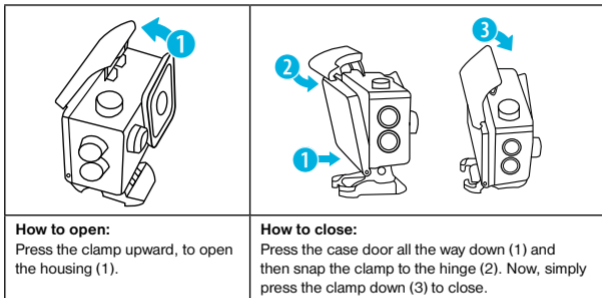

### Inserting microSD card\*

- Class 10 SDHC or higher required
- Capacity up to 32 GB

Note: For best performance, please choose a branded microSD card and format it on your computer before use. Unbranded cards are not guaranteed to work flawlessly.

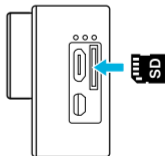



## Installing or removing the battery

- Remove the battery compartment cover.
- Correctly install the battery into the camera.
- Replace the battery compartment cover.

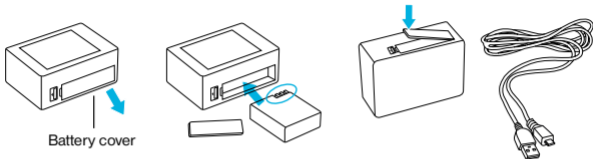

## Charging

- Charging can be done with the power adapter or by connecting the action camera to a computer via the usb cable.
- The action camera can record video while charging
- Charging of the action camera can be done even when it's powered off.

## Turning camera on and off

Press and hold the power switch [  ] for 3 to 5 seconds to turn the camera on or off.



## Functions

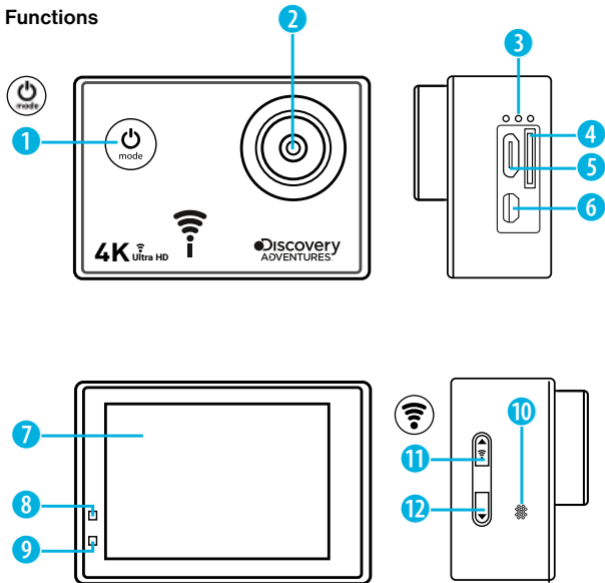

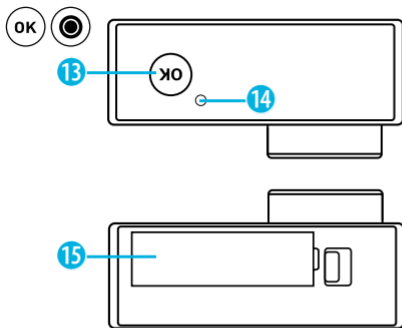

1. Power button (on/off) & Menu & Mode button 

2. Lens

3. Microphone

4. microSD port

5. Micro USB port

6. Micro HDMI port

7. Display



8. Working indicator light

9. Charge indicator

10. Loudspeaker

11. UP + Wi-Fi button 

12. DOWN button

13. OK / Record button  

14. Indicator light

15. Battery cover

## How to use the Base mount

### Flat surface or curved surface mount:

Choose the flat or curved base depending on the surface.

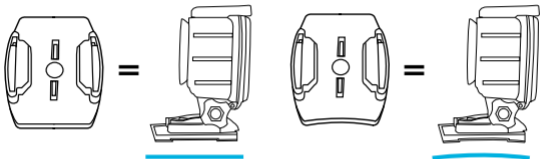

### Base mount (e.g. for helmet mount):

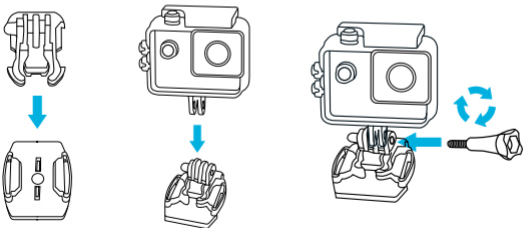

## Mount examples:

### Base mount / Helmet mount:

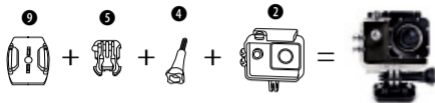

### Helmet mount (Vertical mount)

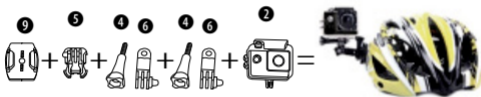

### Bicycle mount:

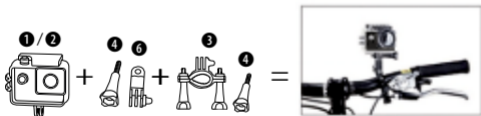



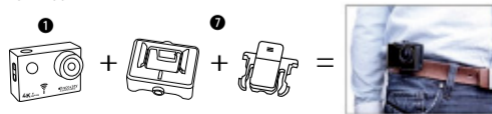

### Belt mount:



# Operating





## Mode Switching

Press the [Power ON/OFF / Mode] button [  ] repeatedly to cycle through the camera modes.

Camera mode	Description
 Video recording mode	Video recording
 Photo shooting mode	Take a single photo
 Playback Mode	Playback videos directly on the TFT screen or via HDMI cable on your TV.
 Settings	Adjust all camera settings





## How to record videos, take photos and configure settings

### Video Recording

Press and hold the power switch [  ] for 3 to 5 seconds to turn the camera on. You will start with the video recording mode. There will be an [  ] icon in the upper left corner. Insert a SD card and start recording by pressing "OK" [  ]. Press "OK" [  ] again if you want to stop the recording. Press and hold the „UP“ or „DOWN“ button to zoom in or out. You can make various option changes under Settings [  ].

## Photo shooting



### Single photo

Switch to photo shooting mode by pressing []. There will be an [] icon in the upper left corner. Press "OK" [] to take a single photo. Press and hold the „UP“ or „DOWN“ button to zoom in or out. You can make various option changes under Settings [].

### Save & Playback

When you are finished recording, you can transfer videos to your computer via USB cable. You can also remove the Micro SD memory card and access the data through a card reader.

### Playback Mode

To enter playback mode, press the [] button repeatedly until the playback icon [] is shown in the upper left corner. Use the „UP“ or „DOWN“ button to switch between the individual recordings. Use the „OK“ [] button to play videos. During playback, you can use the „UP“ and „DOWN“ buttons to fast forward or rewind the videos.



### Deleting videos or photos

Press the [] button repeatedly until you reach the settings menu. You can now delete the last video / photo or all videos / photos under the menu item „Delete“.

### Wi-Fi Mode / Camera App

First, install the app on your smartphone. Look for „OKCam“ in the AppStore or Google Play Store. After installation, press and hold the „UP / Wi-Fi button“ for 3 seconds to activate Wi-Fi on your camera. Connect the camera to your smartphone (find a network with the name displayed on the camera „4K Sports...“). Use the displayed password, usually „12345678“. Start the action camera app now.

## Settings

Press the [  ] button repeatedly until you reach the settings menu. Use the „UP“ and „DOWN“ buttons to navigate through the menu and press the „OK“ [  ] button to enter the selected setting.

Video Resolution	3840*2160@24fps; 2560*1440@30fps; 1920*1080@60fps
Loop recording	Off/ 3min/ 5min/ 10min
Time lapse recording	Off / 1s/ 2s/ 5s/ 10s/ 30s/ 60s
OSD Mode	Off / On
HDR	Off / On
Sound recording	On/ Off
Slow motion	Off/ 720P (120fps) / 240P
Date	Off / On
Motion sensor	Off / On
Gyroscope sensor	Off / On
Picture resolution	16M/14M/12M/8M/5M/2M
Continuous shooting (burst)	Off/ 3x/ 5x/ 10x
Self timer	Off / 2s/ 5s/ 10s/ 20s
Quality	Fine/ Standard/ Economy
Sharpness	Strong/ Standard/ Soft



Exposure	2/ 1,6/ 1,3/ 1/ 0,6/ 0,3/ 0/ -0,3/ -0,6/ -1/ -1,3/ -1,6/ -2
White balance	Auto/ Sunny/ Cloudy/ Artificial light/ Neon light
Colour	Colour/ black and white/ Sepia
ISO	Auto/ 100/ 200/ 400
Delete	Delete last picture / Delete all pictures
File protection	Lock current/ unlock current / Lock all/ unlock all
Date / Time	Set the current date and time
Power saving mode (automatic shutdown)	Off/ 1min/ 2min/ 3min/ 5min/ 10min
Menu button sound	Off/ On
Language	Deutsch, English, Español, Français, Italiano, Português, Polski
Frequency	50Hz/ 60Hz
TV Mode	NTSC/ PAL
TV Out	Off/ On
Screensaver	Off/ 30s/ 60s/ 3min/ 5min
Car Mode	Off/ On

Viewing angle	wide/ average/ narrow
Fish-eye optics	Off/ On
Water Mode	Off/ On
Wlan	Off/ On
Wlan Name (SSID)	Change WIFI User name
Wlan Password	Change WIFI Password
Indicator setting	
Format	All data on the sd card will be deleted
Reset (default settings)	Reset system to default settings
Version	View current firmware version

## Technical Data

TFT Display	2 Zoll (5.08 cm) Bildschirm
Lens	170° wide angle
Waterproof Case	Waterproof up to 30 m
Language options	Deutsch, English, Español, Français, Italiano, Português, Polski
Resolution of photos	12 MP (4032x3024), 10 MP (3648x2736), 8 MP (3264x2448), 5 MP (2592x1944), 3 MP (2048x1536), 2 MP

Resolution of videos	4k (30 fps), 2.7k (30 fps), 1920x1080 (60 fps)
Video format	MP4
Video codec	H.264
Storage	Micro SD card up to 64 GB (not included) (SDHC Class 10 or higher required)
Shooting mode	Single photo / Loop recording / Time Lapse / Burst mode / Self timer
Frequency	50Hz/60Hz
Ports	Micro-USB, Micro-HDMI, microSD card slot
Power source interface	3.7 V
Battery capacity	1050 mAh
Power dissipation	1050 mAh @ 3.7 V
Playback time	ca. 50 minutes (at 4k)
Recording time	ca. 3 hours
Dimensions	60x30x41 mm
Weight	57 g

Note: Specifications could be subject to change due to upgrading or updating.  
Please regard the actual product as the standard.



© 2017 & TM Discovery Communications, LLC. Discovery Adventures™ and logo are trademarks of Discovery Communications, LLC, used under license. All rights reserved.

**OFFICIAL LICENSED PRODUCT**



Bresser GmbH  
Gutenbergstr. 2  
DE-46414 Rhede  
[www.bresser.de](http://www.bresser.de) · [info@bresser.de](mailto:info@bresser.de)

Errors and technical changes reserved.