



**Discovery**  
ADVENTURES

Art.No. 9685103



**EN** Operating instructions

# ACTION CAMERA

Escape // ULTRA HD 4K WIFI

**DE** Besuchen Sie unsere Website über den folgenden QR Code oder Weblink um weitere Informationen zu diesem Produkt oder die verfügbaren Übersetzungen dieser Anleitung zu finden.

**EN** Visit our website via the following QR Code or web link to find further information on this product or the available translations of these instructions.

**FR** Si vous souhaitez obtenir plus d'informations concernant ce produit ou rechercher ce mode d'emploi en d'autres langues, rendez-vous sur notre site Internet en utilisant le code QR ou le lien correspondant.

**NL** Bezoek onze internetpagina via de volgende QR-code of weblink, voor meer informatie over dit product of de beschikbare vertalingen van deze gebruiksaanwijzing.

**IT** Desidera ricevere informazioni esaustive su questo prodotto in una lingua specifica? Venga a visitare il nostro sito Web al seguente link (codice QR Code) per conoscere le versioni disponibili.

**ES** Visite nuestra página de Internet utilizando el siguiente código QR o el enlace web, para buscar más información sobre este producto o versiones disponibles del presente manual de instrucciones en diferentes idiomas.

**PT** Aceda à nossa página na Internet através do seguinte código QR ou hiperligação, para procurar outras informações sobre este produto ou os idiomas disponíveis deste manual de instruções.

**DK** Ønsker du en udførlig vejledning til dette produkt på et bestemt sprog? Så besøg vores website ved hjælp af følgende link (QR-kode) for tilgængelige versioner.

**PL** Odwiedź naszą stronę internetową, korzystając z kodu QR lub za pośrednictwem linka sieciowego, aby poszukać więcej informacji na temat tego produktu lub dostępnych wersji językowych niniejszej instrukcji obsługi.

**RU** Посетите нашу страницу в сети Интернет, используя QR-код или Web-ссылку, для получения дополнительной информации по данному устройству или для поиска доступных языковых версий данного руководства по эксплуатации.

**TR** Bu ürünle ilgili daha fazla bilgi ile bu klavuzun geçerli çevirileri için aşağıdaki Barkod Kodundan ya da web bağlantısından internet sitemizi ziyaret edin.



## FULL MANUAL & VIDEO DOWNLOAD:



[www.bresser.de/download/9685103](http://www.bresser.de/download/9685103)

## APP DOWNLOAD „XDV“:



## SERVICE AND WARRANTY:



[www.bresser.de/warranty\\_terms](http://www.bresser.de/warranty_terms)

## About this Instruction Manual



Please read the safety instructions and the operating instructions carefully before use. Keep these instructions for renewed use at a later date. When the device is sold or given to someone else, the instruction manual must be provided to the new owner/user of the product.

## Intended Use

This product is intended only for private use. It was developed as an electronic medium for the use of multimedia services.



## General Warnings

- **Risk of choking** — Keep packaging material, like plastic bags and rubber bands, out of the reach of children, as these materials pose a choking hazard. This product contains small parts that could be swallowed by children.
- Leaking battery acid can lead to chemical burns. Avoid contact of battery acid with skin, eyes and mucous membranes. In the event of contact, rinse the affected region immediately with a plenty of water and seek medical attention.
- **Risk of electric shock** — Never bend, pinch or pull the power and connecting cables, extensions and adapters. Protect the cables from sharp edges and heat. Before operating, check the device, cables and connections for damage. Never use a damaged unit or a unit with damaged power cables. Damaged parts must be exchanged immediately by an authorised service centre.
- **Risk of property damage!** — Do not disassemble the device. In the event of a defect, please contact your dealer. The dealer will contact the Service Centre and can send the device in to be repaired, if necessary.
- Do not expose the device to high temperatures. Use only the supplied power adapter. Do not short-circuit the device or throw them into a fire. Excessive heat or improper handling could trigger a short-circuit, a fire or an explosion.

- Do not interrupt an on-going data connection to a computer before all data has been transferred. This could lead to data loss for which the manufacturer is not liable.

## Notes on cleaning

- Turn off the camera
- Clean the eyepieces and/or lenses only with a soft, lint-free cloth, (e.g. microfibre cloth). To avoid scratching the lenses, use only gentle pressure with the cleaning cloth.
- Only use a dry cloth to clean the exterior of the device. To avoid damaging the electronics, do not use any cleaning fluid.
- Clean the protective case after each use with clear, clean water and dry it thoroughly.

## EC Declaration of Conformity



Bresser GmbH has issued a Declaration of Conformity' in accordance with applicable guidelines and corresponding standards. This can be viewed any time upon request.

## Disposal



Dispose of the packaging materials properly, according to their type, such as paper or cardboard. Contact your local waste-disposal service or environmental authority for information on the proper disposal.



Do not dispose of electronic devices in the household garbage!  
As per the Directive 2002/96/EC of the European Parliament on waste electrical and electronic equipment and its adaptation into German law, used electronic devices must be collected separately and recycled in an environmentally friendly manner. Empty, old batteries must be disposed of at battery collection points by the consumer. You can find out more information about the disposal of devices or batteries produced after 6 January 2006 from your local waste-disposal service or environmental authority.



The integrated battery must only be removed for disposal. Opening the device housing can damage the unit.

Drain the battery completely before disposal. Remove all the screws in the housing and open the device housing. Remove the connections to the battery and remove it. Cover the open contacts with tape and package the battery in such a way that it cannot shift in the packaging.

## **Warranty & Service**

The regular guarantee period is 2 years and begins on the day of purchase. To benefit from an extended voluntary guarantee period as stated on the gift box, registration on our website is required. You can consult the full guarantee terms as well as information on extending the guarantee period and details of our services at [www.bresser.de/warranty\\_terms](http://www.bresser.de/warranty_terms).

## Scope of delivery

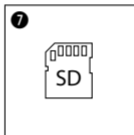
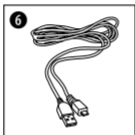
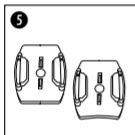
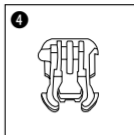
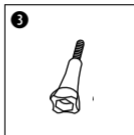
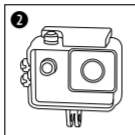
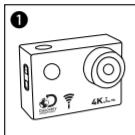

- 1 Camera
- 2 Waterproof case
- 3 Thumb knobs
- 4 Retaining clip for Base mount
- 5 Base for flat and curved surface
- 6 USB cable
- 7 8 GB MicroSD card

## First Steps

How to open and close the waterproof case:

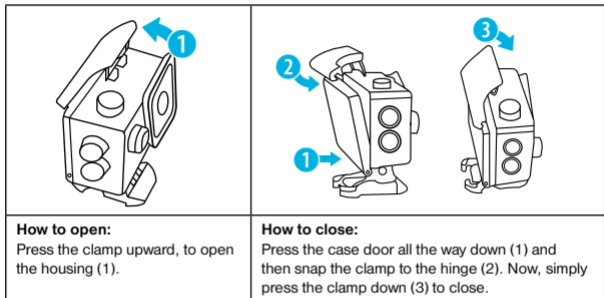

### Inserting microSD card

- Class 10 SDHC or higher required
- Capacity up to 64 GB

Note: For best performance, please choose a branded microSD card and format it on your computer before use. Unbranded cards are not guaranteed to work flawlessly.

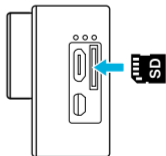



## Installing or removing the battery

- Press on the battery cover to open it
- Correctly install the battery into the camera.
- Remove Battery: Simply open battery cover to take the battery out.

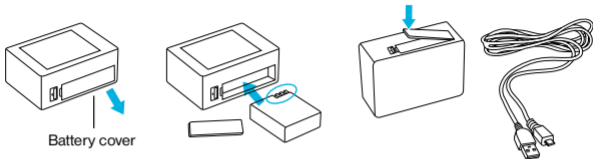

## Charging

- Charging can be done with the power adapter or by connecting the action camera to a computer via the usb cable.
- The action camera can record video while charging
- Charging of the action camera can be done even when it's powered off.

## Turning camera on and off

Press and hold the power switch [  ] for 3 to 5 seconds to turn the camera on or off.



## Functions

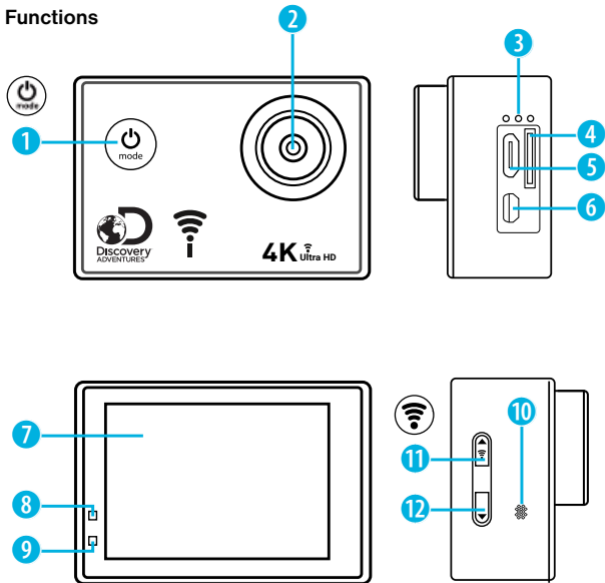

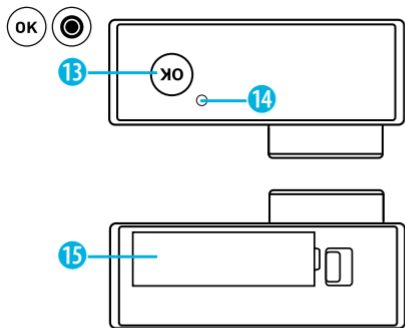

1. Power button (on/off) & Menu & Mode button 

2. Lens

3. Microphone

4. microSD port

5. Micro USB port

6. Micro HDMI port

7. Display



8. Charge indicator

9. Working indicator light

10. Loudspeaker

11. UP + Wi-Fi button 

12. DOWN button

13. OK / Record button  

14. Indicator light

15. Battery cover

## How to use the Base mount

### Flat surface or curved surface mount:

Choose the flat or curved base depending on the surface.

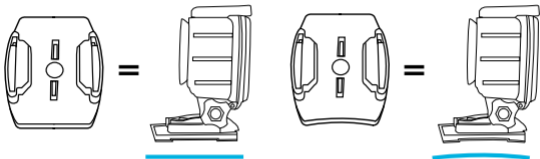



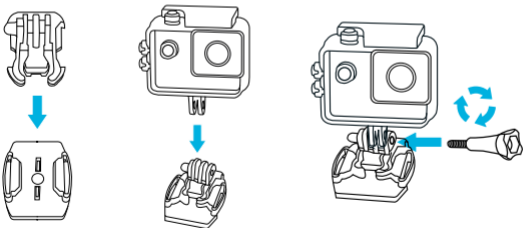



### Base mount (e.g. for helmet mount):



# Operating



## Mode Switching

Press the [Power ON/OFF / Mode] button [  ] repeatedly to cycle through the camera modes.

Camera mode	Description
 Video recording mode	Video recording
 Photo shooting mode	Take a single photo
 Slow motion recording	Take a slow motion video
 Playback Mode	Playback videos directly on the TFT screen or via HDMI cable on your TV.
 Settings	Adjust all camera settings

## How to record videos, take photos and configure settings

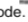
### Video Recording





Press and hold the power switch [  ] for 3 to 5 seconds to turn the camera on. You will start with the video recording mode. There will be an [  ] icon in the upper left corner. Insert a SD card and start recording by pressing "OK" [  ]. Press "OK" [  ] again if you want to stop the recording. Press and hold the „UP“ or „DOWN“ button to zoom in or out.

You can make various option changes under Settings [  ].

## Photo shooting

Switch to photo shooting mode by pressing [  ]. There will be an [  ] icon in the upper left corner. Press „OK“ [  ], to take a single photo. Press and hold the „UP“ or „DOWN“ button to zoom in or out. You can make various option changes under Settings [  ].

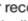

## Take slow motion videos

Press the [  ] button again to enter the slow motion video [  ] mode. Press „OK“ [  ], for recording with slow motion. Press „OK“ [  ] again to stop recording. The camera automatically reduces the speed by half, making the videos twice as long. You can make various option changes under Settings [  ].

## Save & Playback

When you are finished recording, you can transfer videos to your computer via USB cable. You can also remove the Micro SD memory card and access the data through a card reader.

## Playback Mode

To enter playback mode, press the [  ] button repeatedly until the playback icon [  ] is shown in the upper left corner. Use the „UP“ or „DOWN“ button to switch between the individual recordings. Use the „OK“ [  ] button to play videos.

## Delete a specific file or image

A specific file or image can be deleted by pressing and holding the „OK“ button in Playback mode. A window will open, so that you can confirm that you want to delete this file.





## Wi-Fi Mode / Camera App

First, install the app on your smartphone. Look for „XDV“ in the AppStore or Google Play Store. After installation, press the „Wi-Fi button [  ]“ to activate Wi-Fi on your camera. Connect the camera to your smartphone (find a network with the name displayed on the camera „SportsDV“). Use the displayed password, usually „1234567890“. Start the action camera app now.

## Connection issues

It may happen that after some time the message „WIFI has no Internet access“ or „The network has no Internet access - keep connection? appears. Select „No more questions for this network and confirm with“ YES „.

## Settings

To access the settings, press [  ] several times until you see the icon [  ] for the settings. Now press “OK” [  ] to open the menu. Use the [  ] button to switch between the various submenus. Video, photo, image and system settings.

## Video menu

Video resolution	4K (3840x2160 ) @ 30fps; 2.7K @ 30fps; 1920x1080@60fps; 1920x1080@30fps; 1280x720@120fps; 1280x720 @ 60fps
Sound recording	On/ Off
Time lapse	Off / 0,5s/ 1s/ 2s/ 5s/ 10s/ 30s/ 60s
Looping video	Off/ 2min/ 3min/ 5min
Slow motion resolution	1080P @ 60fps / 720P @ 120fps
Motion sensor	On/ Off
Viewing angle	near/wide/average/narrow

## Photo menu

Picture resolution	2M/ 5M/ 8M/ 12M/ 16M
Self timer	Off/ 3s/ 5s/ 10s/ 20s
Automatic shooting	Off/ 3s/ 10s/ 15s/ 20s/ 30s
Continuous shooting (burst)	Off/ 3x/ 5x/ 10x

## Other settings

Exposure	-3/ -2/ -1/ 0/ 1/ 2/ 3
White balance	Auto/ Sunny/ Cloudy/ Artificial light/Neon light
Wlan	On/ Off
Rotate the screen	On/ Off
Car Mode	On/ Off
Mains frequency	Auto/ 50Hz/ 60Hz
Status LED	On/ Off
Screensaver	10s/ 20s/ 30s/ Off
Power saving mode	1 min/ 3min/ 5min/ Aus
Date/Time stamp	Off/ On



## System settings

Language	Deutsch, English, Español, Français, Italiano, Português, Polski
Date / Time	YYYY/MM/DD HH:MM:SS
Format	All data on the sd card will be deleted
Reset (default settings)	Reset system to default settings
Version	View current firmware version

## Technical Data

TFT Display	2 Zoll (5.08 cm) display 0.94 Zoll (2.4 cm) OLED front display
Lens	170° wide angle
Waterproof Case	Waterproof up to 30 m
Language options	Deutsch, English, Español, Français, Italiano, Português, Polski
Resolution of photos	12 MP (4032x3024), 10 MP (3648x2736), 8 MP (3264x2448), 5 MP (2592x1944), 3 MP (2048x1536), 2 MP
Resolution of videos	4K( 30fps); 2.7K (30fps); 1920*1080 (60fps); 1920*1080 (30fps); 1280*720 (120fps) 1280*720 (60fps)

Video format	AVI
Video codec	H.264
Storage	Micro SD cards up to 64 GB (SDHC Class 10 or higher required)
Shooting mode	Single photo / Loop recording / Time Lapse / Burst mode / Self timer / Automatic shooting
Frequency	50Hz/60Hz
Ports	Micro-USB, Micro-HDMI, microSD card slot
Power source interface	3.7 V
Battery capacity	1050 mAh
Power dissipation	1050 mAh @ 3.7 V
Playback time	ca. 50 minutes (at 4k)
Recording time	ca. 3 hours
Dimensions	60x30x41 mm
Weight	57 g

Note: Specifications could be subject to change due to upgrading or updating.  
Please regard the actual product as the standard.





© 2017 & TM Discovery Communications, LLC.  
Discovery Adventures™ and logo are trademarks of  
Discovery Communications, LLC, used under license.  
All rights reserved.

**OFFICIAL LICENSED PRODUCT**



Bresser GmbH  
Gutenbergstr. 2  
DE-46414 Rhede  
[www.bresser.de](http://www.bresser.de) · [info@bresser.de](mailto:info@bresser.de)

Errors and technical changes reserved.